

Designer: AWH
 Date: 4/24/2014
 Scale: 1"-4"
 Sheet #: 1
 Drawing: 000614

REVISIONS		
#	Change	Date
1		10/23/14
2		11/20/14

This drawing, the original landscape design, specifications, & details, depicted herein as instruments of service, are the sole & exclusive property of Clearwater Landscape & Nursery.
 No reproductions or use of this drawing, specifications, &/or details depicted herein shall be made without the expressed written permission of Clearwater Landscape & Nursery.

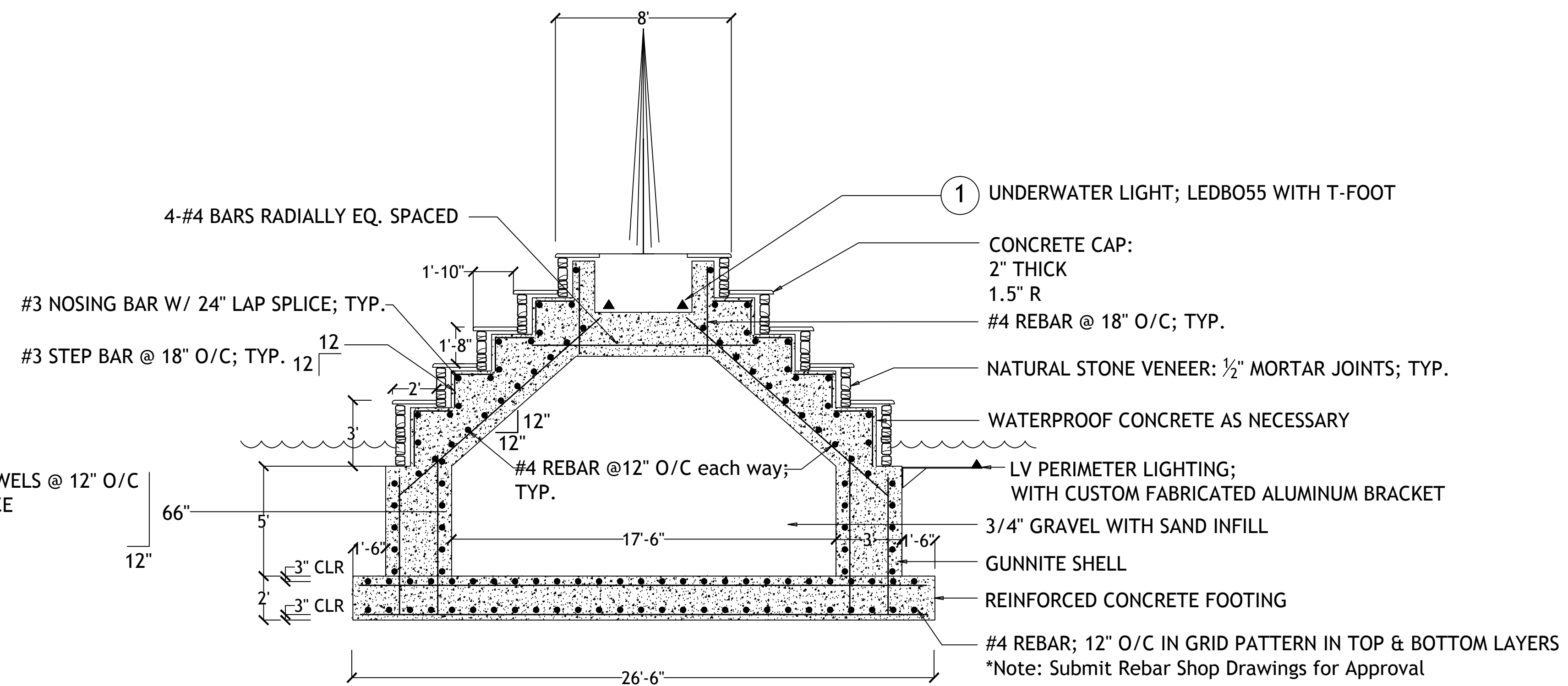
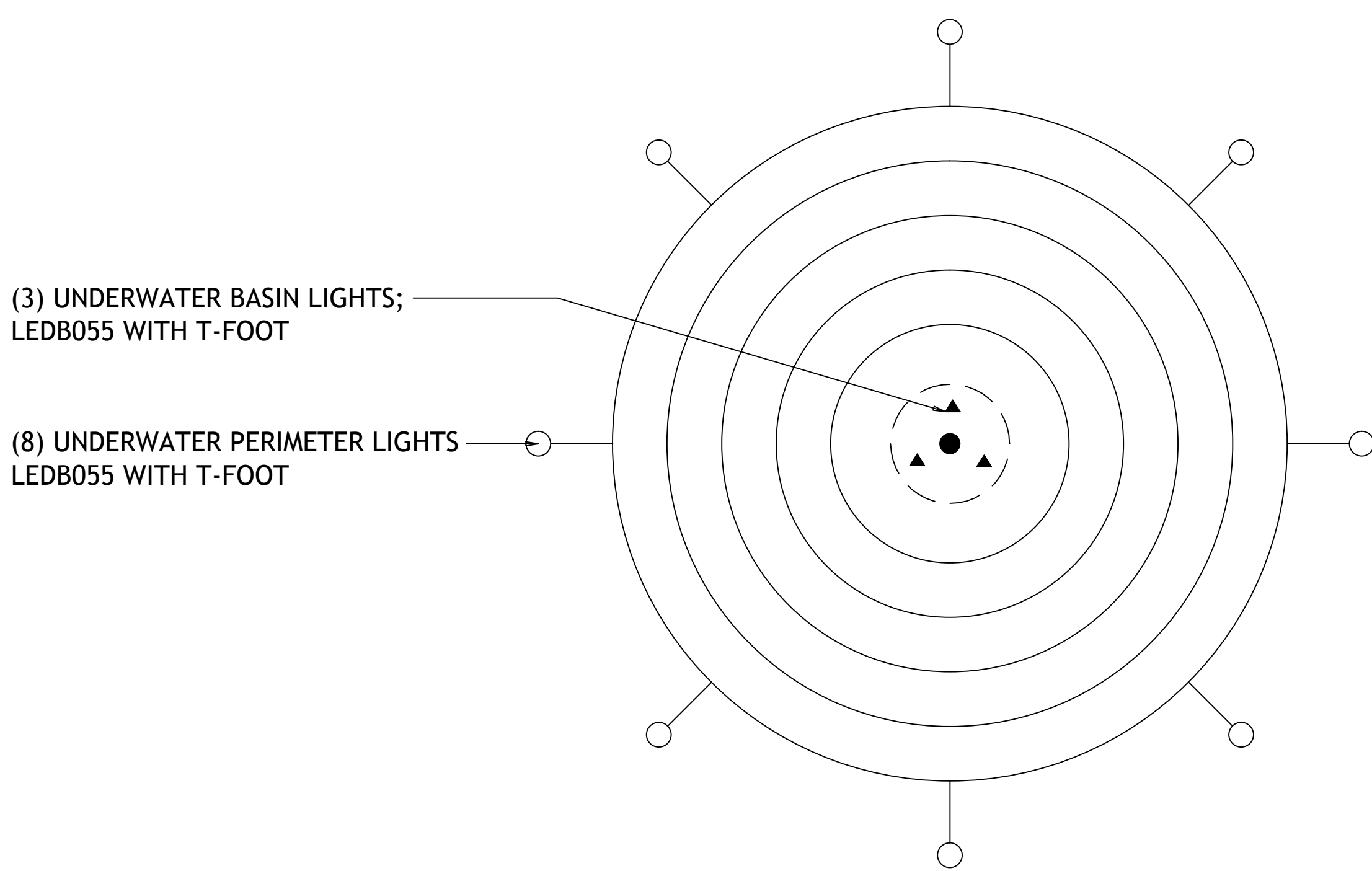

STRUCTURAL NOTES

1. Design Criteria
 - a. 100-year floodplain WSE 295.0
 - b. Normal WSE 287.20
 - c. Lake bottom elevation 281.70
2. Revisions or modifications to the engineering requirements shown on these plans shall be approved in advance by the Structural Engineer prior to proceeding with construction.
3. The foundation for the fountain shall be placed on suitable soils and bearing conditions with a presumed allowable soil bearing capacity equal to 2,500 psf. If questionable or unsuitable materials are encountered, these materials shall be removed and the foundation should be lowered to competent soils or placed on approved compacted material.
4. All concrete shall be a minimum of 4,000 psi compressive strength at 28 days. Air-entrained concrete shall be used for all concrete exposed to weather or earth with 4 to 6 percent air entrainment. Concrete slump shall be 4" average and 5" maximum.
5. Reinforcing bars shall be deformed bars conforming to ASTM A-615, Grade 60. Reinforcement placement shall be placed with minimum concrete protection for all reinforcing steel: 3" for concrete cast against earth, 1 1/2" when formed and exposed to earth or weather, and 3/4" otherwise.

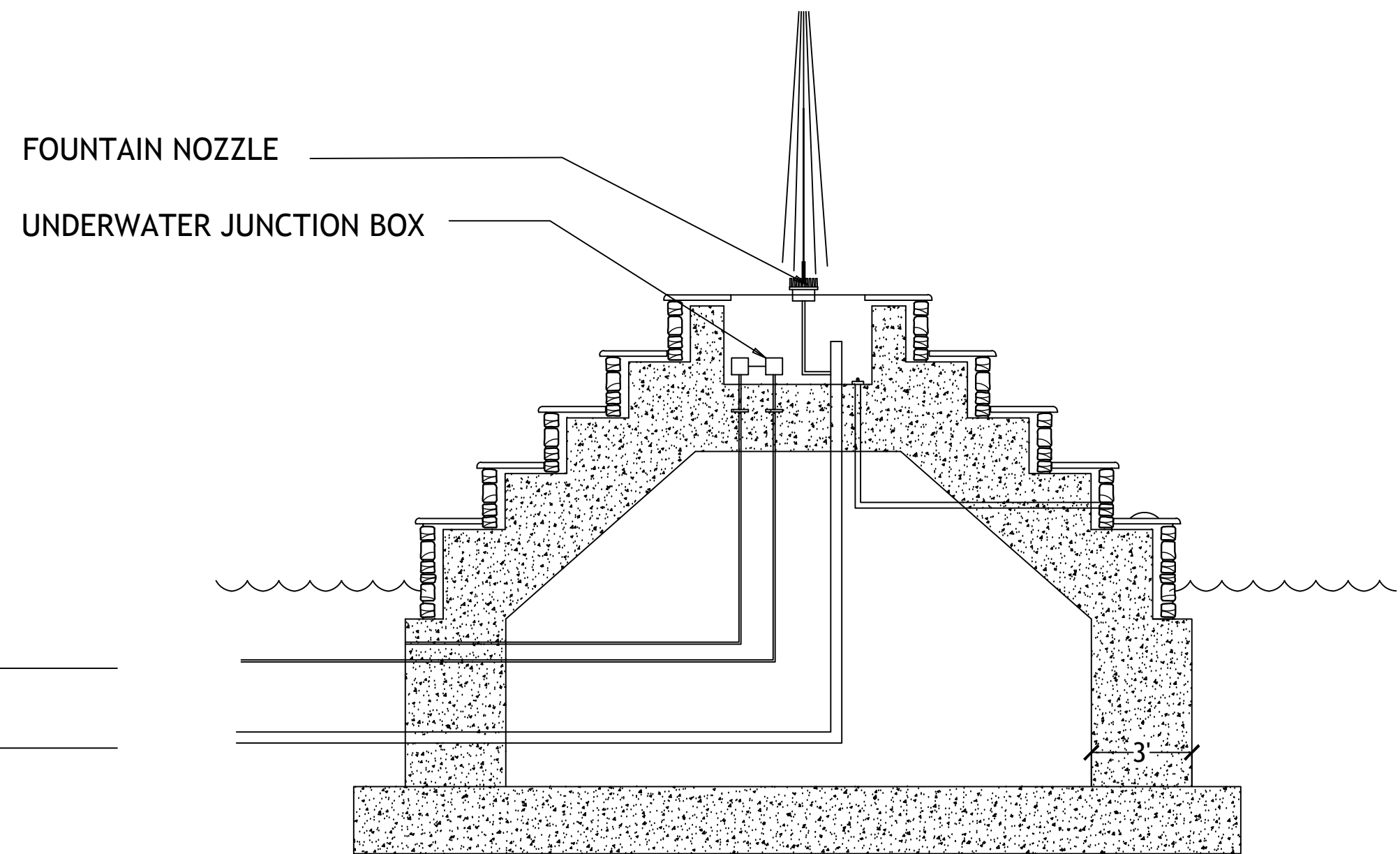
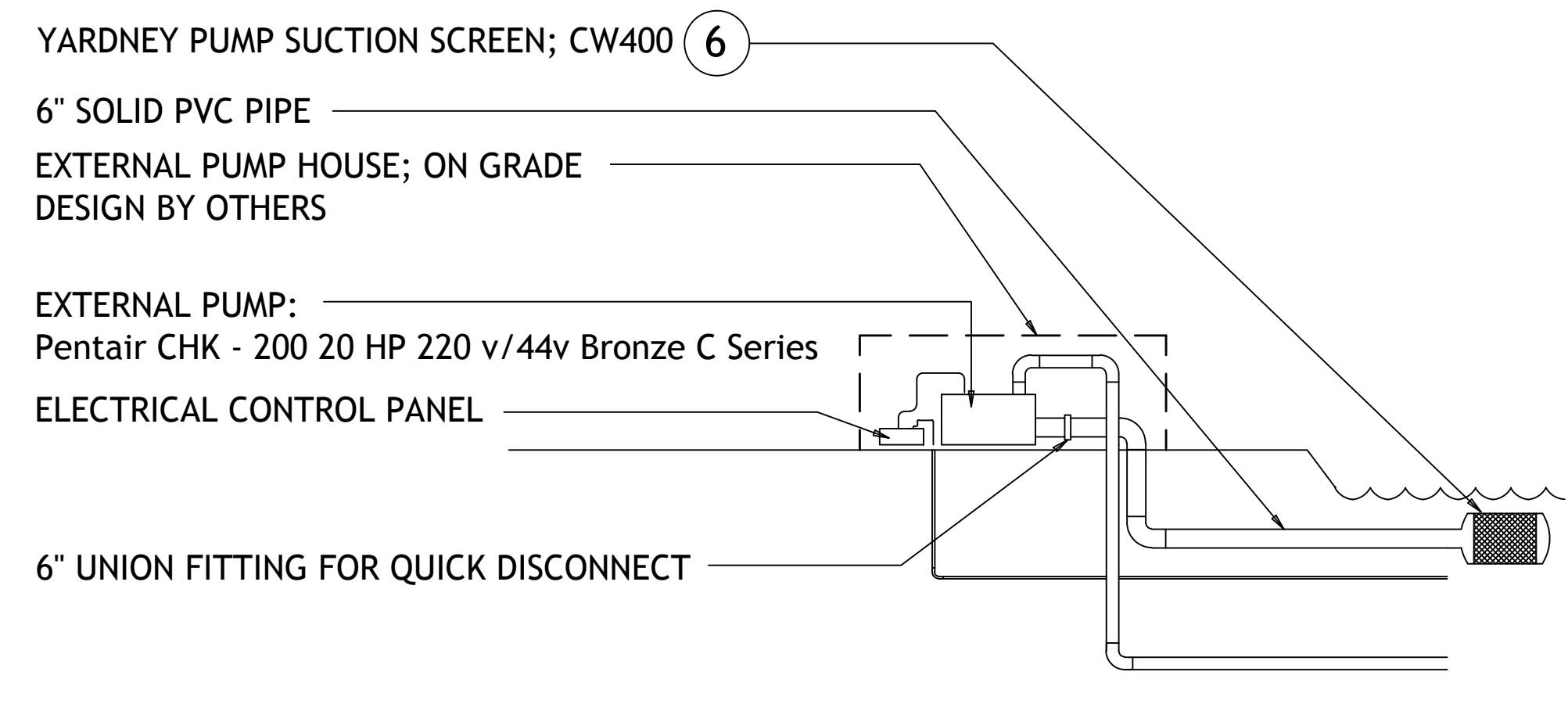
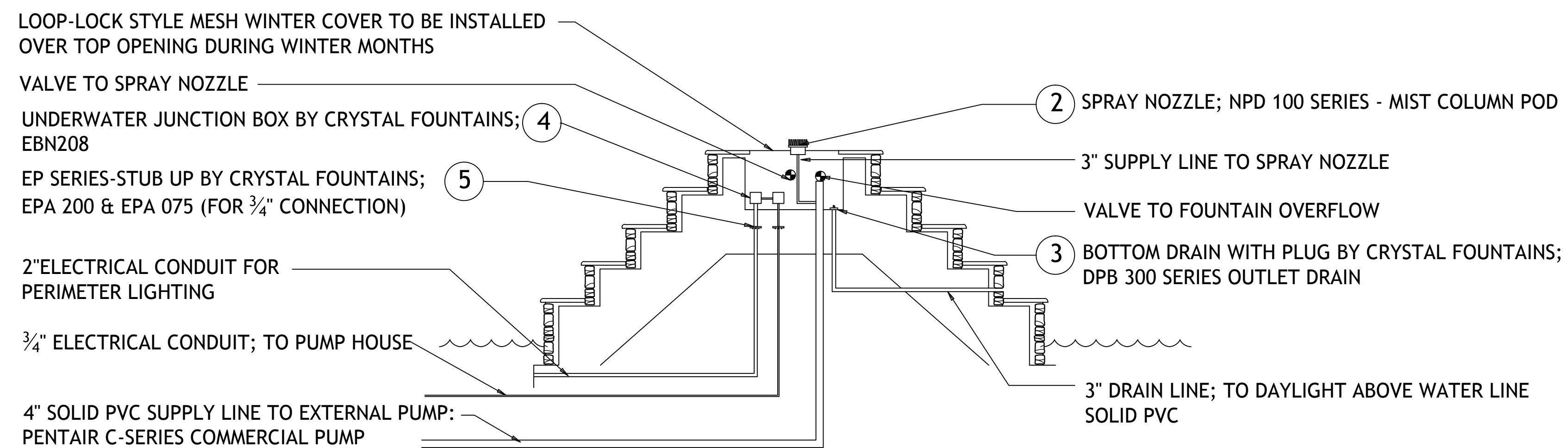

I certify that this drawing was prepared for my review and approval only the structural design under my supervision to be issued for a building permit and for construction, and that I am a duly licensed professional engineer under the laws of the State of Maryland, License No. 9246, Expiration Date: June 5, 2015

Pecora Engineering, LLC
 1309 Orchard Way
 Frederick, MD 21703

Fountain @ Culler Lake
 Baker Park | Frederick, MD

CLEARWATER
 Landscape & Nursery
 9585 Doctor Perry Road
 Ijamsville, Maryland 21754
 301.607.4480 (phone)
 301.607.4481 (fax)
 www.clearwaterlandscape.com

